

CHEMISTRY EQUIPMENT WS (HOMEWORK)

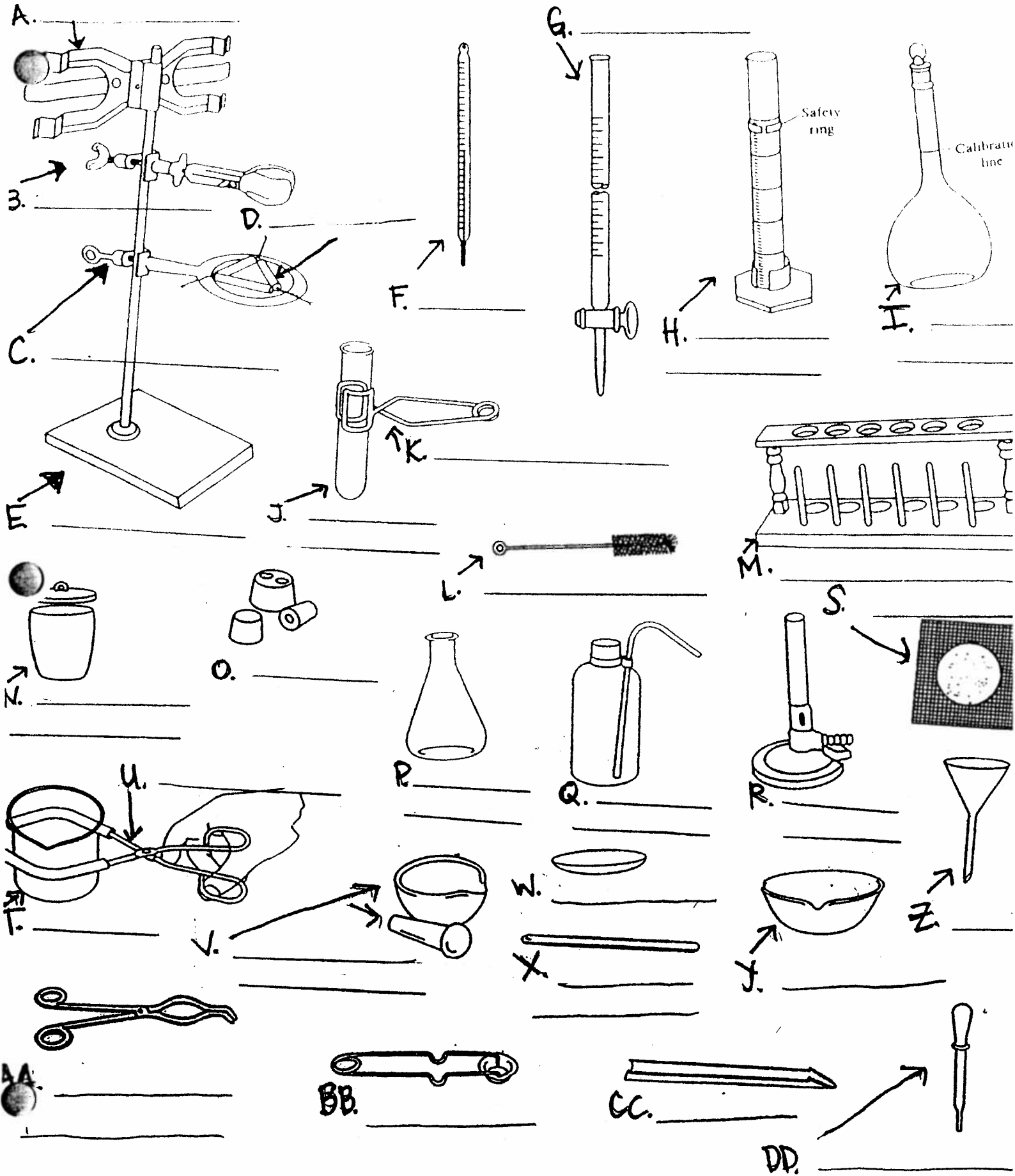

Glassware

___ beaker	to hold liquids, common sizes are 50-mL, 100-mL, 250-mL, 400-mL; may be heated
___ Erlenmeyer flask	triangular shaped flask used in titrations; may be heated; common sizes are 100-mL, 250-mL
___ volumetric flask	flask with a long neck that has an etched mark on the neck for volume; used for making and storing solutions
___ graduated cylinder	cylinder shaped container with markings used to measure approximate, volumes; may NOT be heated; common sizes are 10-mL, 50-mL, 100-mL
___ test tube	a simple tube of thin glass, for heating solutions and for performing reactions
___ buret	long tube with markings and a stopcock on bottom used to measure volumes of solutions used in titrations; common sizes are 25-mL and 50-mL
___ dropping pipet	glass tip with rubber bulb; used to transfer small volume of liquid
___ watch glass	used to cover an evaporating dish or beaker

Porcelain Equipment

___ crucible with lid	used to heat small amounts of solid substances at high temperatures
___ evaporating dish	used to contain small volumes of liquid being evaporated
___ mortar & pestle	used to grind crystals and lumpy chemicals to a powder

Miscellaneous Supports

___ test tube rack	wood or plastic; used to hold test tubes in a vertical position
___ clay triangle	wire frame with porcelain supports used to support a crucible over a burner
___ ring stand	metal rod fixed upright in a heavy metal base; has many uses as a support
___ wire gauze	used to spread the heat of a burner flame and support glassware over a flame
___ ring clamp	an iron ring clamped to a ring stand support
___ test tube clamp	used to hold a buret or test tube and supported by a ring stand
___ buret clamp	spring-loaded clamp used to support one or two burets
___ test tube holder	spring metal; used to hold test tubes or glass tubing by hand
___ crucible tongs	made of iron or nickel and used to pick up and hold small items such as a crucible and lid
___ beaker tongs	ends are coated in rubber and is used to hold beakers by hand

Other Miscellaneous

___ scoop	it is used to transfer solid chemicals
___ stirring rod	glass; used to stir and assist in pouring liquids
___ thermometer	alcohol or mercury in glass; common range -10°C to 110°; used to measure temperature
___ funnel	glass or plastic; common size holds 12.5-cm diameter filter paper; used to filter
___ rubber stoppers	used with test tubes or flasks to store chemicals
___ test tube brush	bristles with wire handle, used to scrub small diameter glassware
___ wash bottle	flexible plastic; squeeze sides to dispense water
___ Bunsen burner	a gas burner used in laboratories; has an air valve to regulate the mixture of gas and air